



9000XE shower kit Vaska

9000XE shower kit is our complete shower kit with a mixer and shower set in chrome. The mixer, combined with the large nozzle, delivers a pleasant shower experience with good pressure and an ample jet range without wasting water. The shower kit is easy to install in all types of bathrooms. The product can be supplemented with a tub spout.

Article number: 86890000 **RSK:** 8283241 **Flow 3 bar:** 6.9 l/m

Description: Chrome, 40 c/c, pipe connection up

- Note! 40 c/c
- Safety mixer 9000XE and shower set 9000XE
- Shower set has anti lime-scale hand shower, shower bar with slider, soap dish and wall brackets with sealing
- Lead Free material

Unique characteristics



Backflow protection unit type **EB**

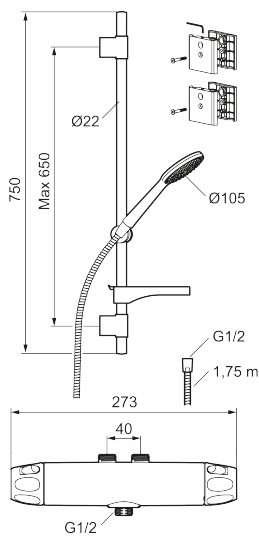

PRODUCT DESCRIPTION

9000XE shower kit Vaska

9000XE shower kit is our complete shower kit with a mixer and shower set in chrome. The mixer, combined with the large nozzle, delivers a pleasant shower experience with good pressure and an ample jet range without wasting water. The shower kit is easy to install in all types of bathrooms. The product can be supplemented with a tub spout.

Article number: 86890000

RSK: 8283241

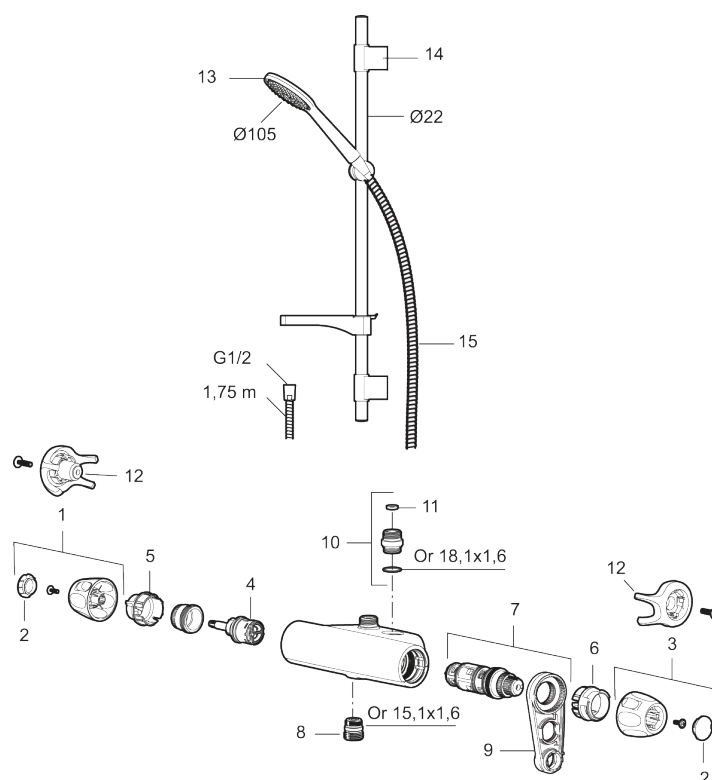

Sparepartlist

| NO. | FMM NO. | RSK | DESCRIPTION |
|-----|------------|---------|--------------------------------------------------------------|
| 1 | S600083 | 8218917 | On/off handle, complete, krom |
| 1 | S600083.75 | 8218919 | On/off handle, complete, brushed chrome |
| 2 | S600116 | 8218920 | End cover, chrome |
| 2 | S600116.75 | 8218922 | End cover, brushed chrome |
| 3 | S600082 | 8218914 | Temperature handle, complete, chrome |
| 3 | S600082.75 | 8218916 | Temperature handle, complete, brushed chrome |
| 4 | S600020 | 8441462 | Reversible headwork shower mixer 12 l/min, with service tool |
| 4 | S600269 | 8387232 | Reversible headwork shower mixer 12 l/min |
| 5 | S600086 | 8439710 | Stop ring, for one outlet (down or up) |
| 6 | S600087 | 8439711 | Scalding protection ring, max 50°C |

| NO. | FMM NO. | RSK | DESCRIPTION |
|-----|------------|---------|--------------------------------------------------------|
| 7 | S600084 | 8439709 | Thermostatic cartridge, complete, incl. service tool |
| 7 | S600271 | 8397030 | Thermostatic cartridge, complete, without service tool |
| 8 | S600088 | 8439712 | Nipple M18x1–G1/2 for shower mixer |
| 9 | S600298 | 3870203 | Service tool |
| 10 | 59820800 | 8591970 | Inlet connector |
| 11 | 38632006 | 8590311 | Filter |
| 12 | S600105 | 8439713 | Care-handle, black, 2 pcs |
| 13 | S600091 | 8233001 | Hand shower, chrome |
| 13 | S600091.75 | 8233003 | Hand shower, brushed chrome |
| 14 | S600095 | 8239500 | Wall bracket, chrome |
| 14 | S600095.75 | 8221926 | Wall bracket, brushed chrome |
| 15 | S600109 | 8252036 | Shower hose, chrome |
| 15 | S600109.75 | 8252038 | Shower hose, brushed chrome |